

**A2HC COVID NON-ACUTE  
CAT 3 - AMBULATORY  
WITH SOME ACUTE  
COVID PATIENT (HYBRID)  
TRANSITION AREA  
CONCEPTUAL LAYOUTS**

DRAWINGS ARE NOT TO SCALE

ZONE 1 - REST OF FACILITY/ BUILDING  
CENTRAL UTILITIES / FACILITY INFRASTRUCTURE

ZONE 2 - CENTRAL SUPPORT AREAS  
(LAUNDRY, STAFF LOCKER/SHOWERS, QUARTERS  
PHARMACY, DINING, BREAK, TEAM ROOM, MORGUE, ETC.)

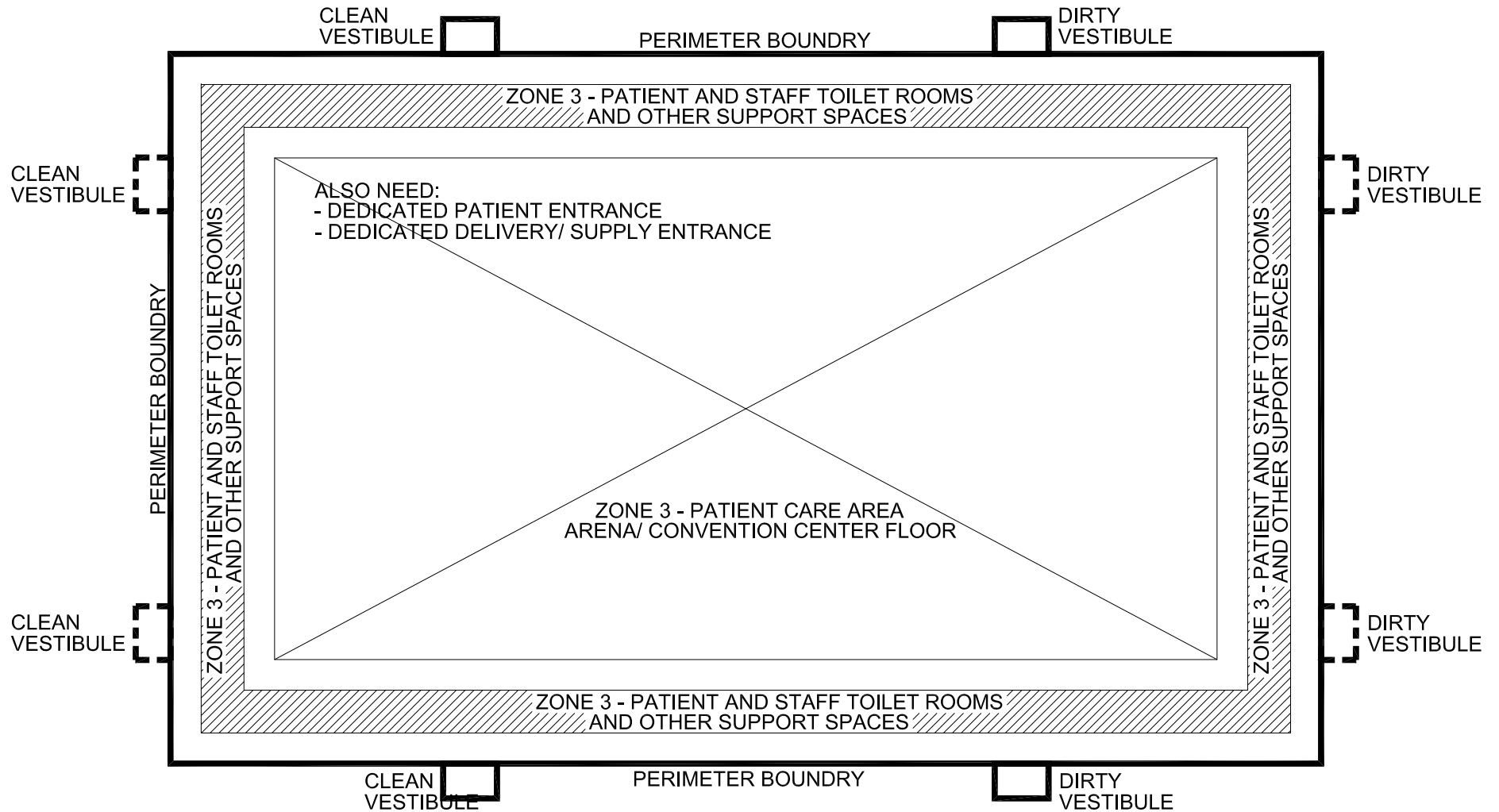

## A2HC COVID+ NON-ACUTE DEFINITIONS:

NOTE: THE CONTAINED INFORMATION IS CONCEPTUAL ONLY AND NOT INTENDED TO BE FULL DESIGNS. LAYOUTS MUST BE COORDINATED WITH EACH RESPECTED SITE, CONOPS AND AVAILABLE SPACE NEEDS. MODULAR IN NATURE FOR ADAPTATION.

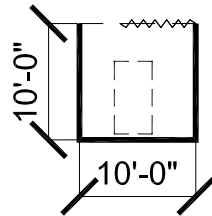

10x10 PATIENT CARE SPACE  
WITH THREE WALLS AND CURTAIN FRONT

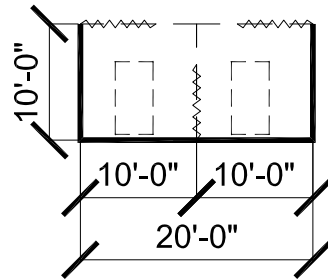

10x20 PATIENT CARE SPACE  
WITH CURTAIN DIVIDER AND CURTAIN FRONT

## A2HC - COVID+ NON-ACUTE PATIENT ROOM/OPEN CUBE ARRANGEMENT

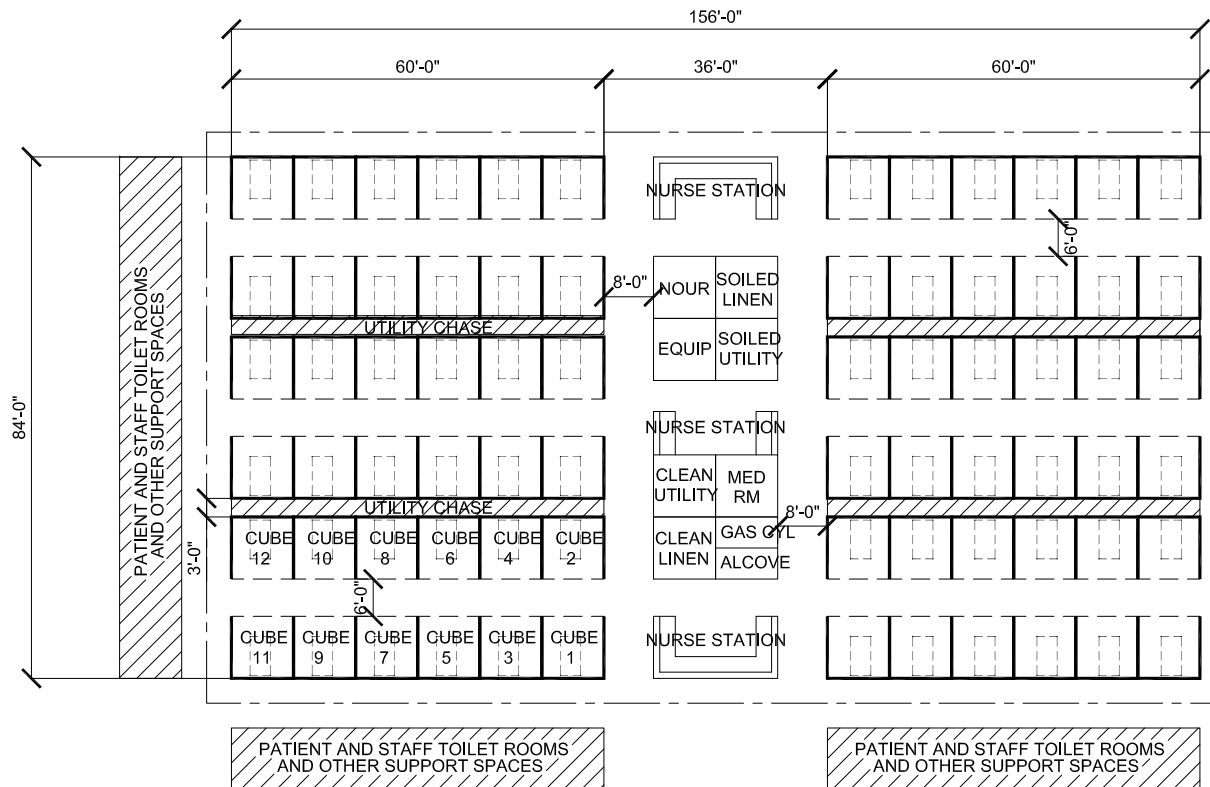

13,104 SF  
 A2HC - NON-ACUTE COVID+ PATIENT ROOM ARRANGEMENT  
 (72) PATIENT BLOCK (CAT 3 NON-ACUTE AMBULATORY)

**ASSUMPTIONS:**

1. ENTIRE ARENA/CONVENTION AREA HAS DEDICATED HVAC SYSTEM - EXHAUST (NO NEGATIVE AIR DEDICATED FOR EACH ROOM/ OPEN CUBE)
2. ENTIRE ARENA/CONVENTION AREA CONSIDERED INFECTIOUS/HOT FOR COVID POSITIVE PATIENTS
3. CLEAN ENTRANCE VESTIBULE (DONNING) AND DIRTY EXIT VESTIBULE (DOFFING) PROVIDED AT PERIMETER OF CONVENTION CENTER/ARENA AREA/ZONE
4. PIPED OXYGEN OR BOTTLED TANKS TO BE PROVIDED WITH OPTIONAL TELEMETRY, PULSE OXIMETRY AT BEDSIDE AND CAMERA'S FOR OBSERVATION FOR EACH ROOM/OPEN CUBE
5. 8 FEET CORRIDORS STILL PREFERRED FOR AMBULANCE STRETCHER ACCESS (EMERGENCY). COULD GO DOWN TO 6 FT FOR SECONDARY CORRIDORS
6. CONCEPTUAL LAYOUT INCORPORATES MAX 100 FT TRAVEL DISTANCE ANY DIRECTION TO EXIT ACCESS (DICTATES PATIENT MODULES)
7. ANTICIPATED NURSE TO PATIENT RATIO: 1 OR 2 NURSES PER 8 TO 12 OPEN CUBES (ROW) - MODULES CAN BE REDUCED
8. ONE SMALL NURSE STATION PROVIDED ADJACENT TO OR DEDICATED FOR RESPECTIVE ADJACENT PATIENT ROWS FOR QUICK RESPONSE/ ACCESS
9. ONLY NECESSARY SUPPORT ROOMS SHOWN IN CONCEPTUAL PLAN. OTHER ROOMS, TOILETS, ETC. ARE TO BE PROVIDED ELSEWHERE WITHIN PATIENT CARE AREA

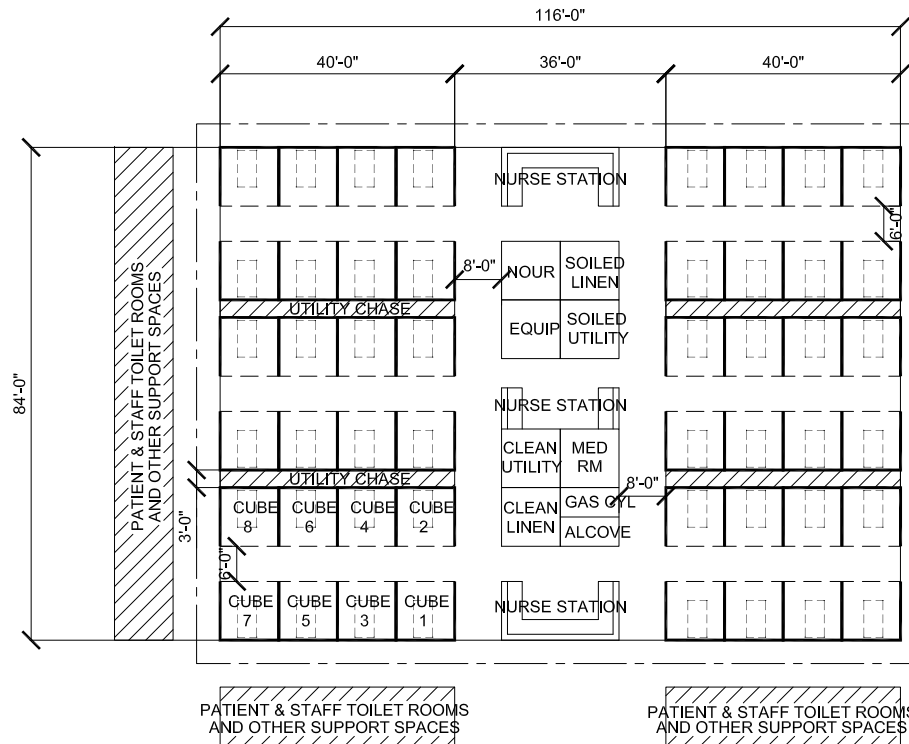

9,744 SF  
 A2HC - NON-ACUTE COVID+ PATIENT ROOM ARRANGEMENT  
 (72) PATIENT BLOCK (CAT 3 NON-ACUTE AMBULATORY)



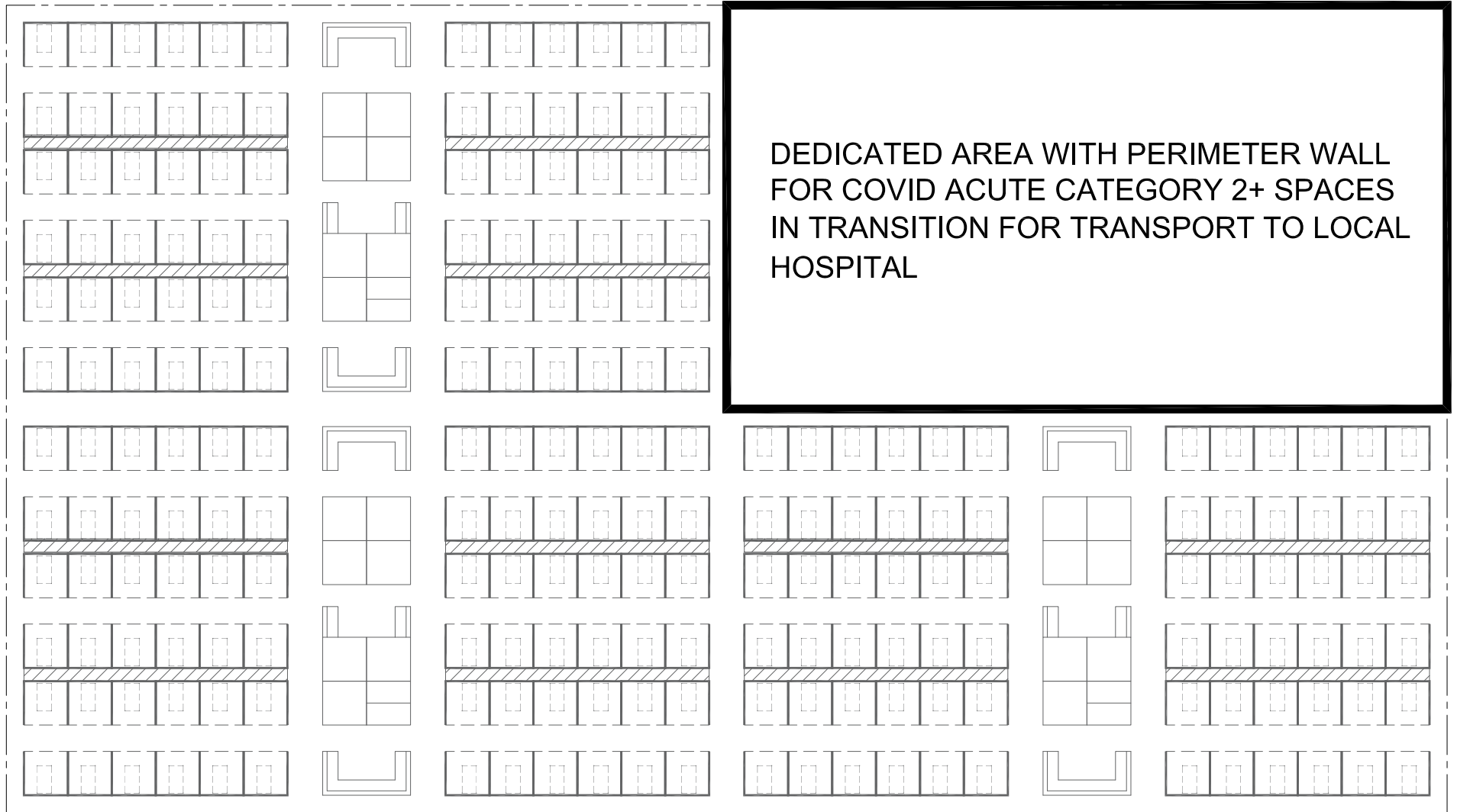

NOTE: FOR A2HC COVID ACUTE DEDICATED AREA - REFERENCE SPECIFIC PWS AND/OR CONCEPTUAL LAYOUTS WITHIN LATEST HNC BINDER

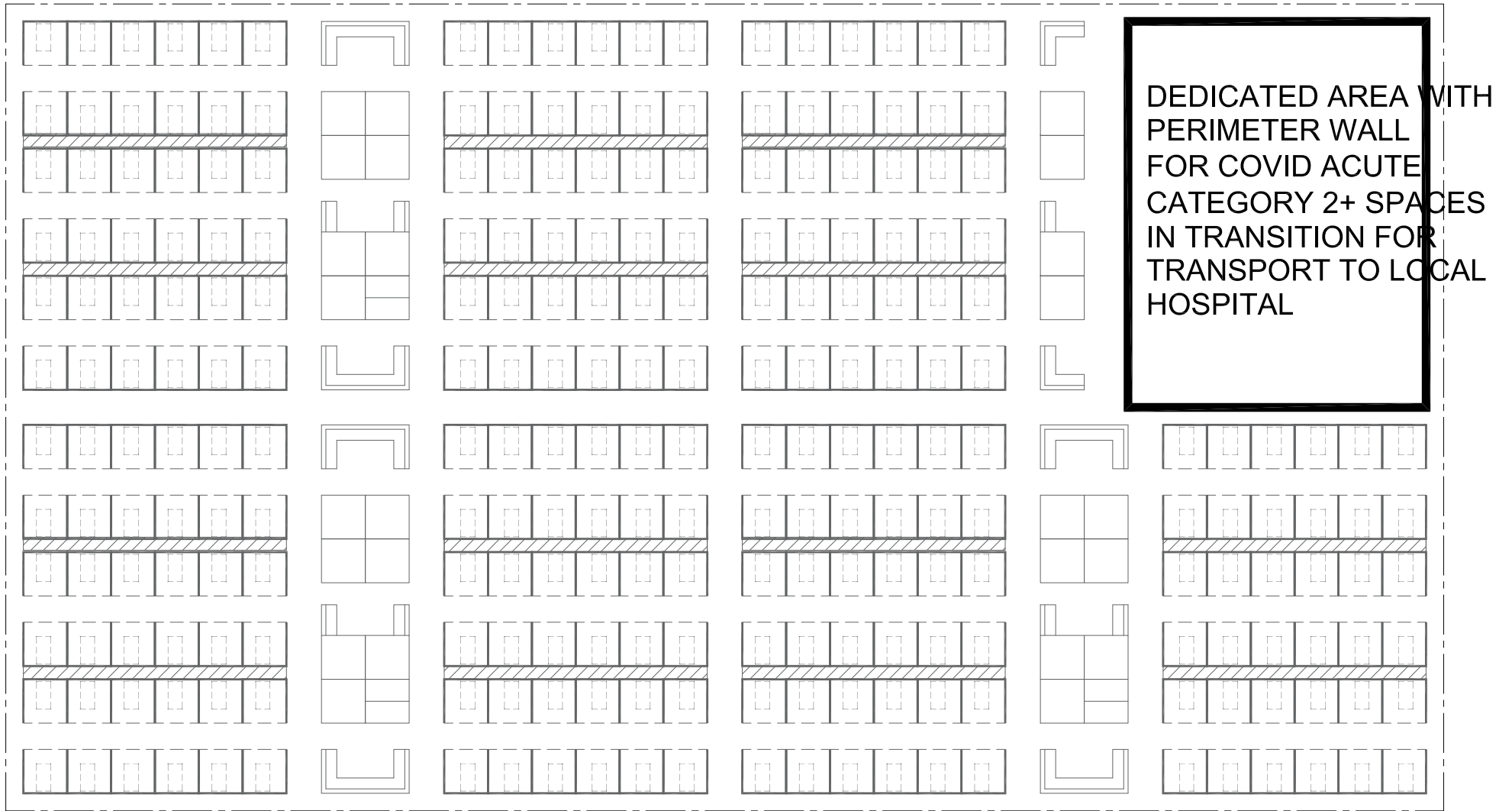

NOTE: FOR A2HC COVID ACUTE DEDICATED AREA - REFERENCE SPECIFIC PWS AND/OR CONCEPTUAL LAYOUTS WITHIN LATEST HNC BINDER



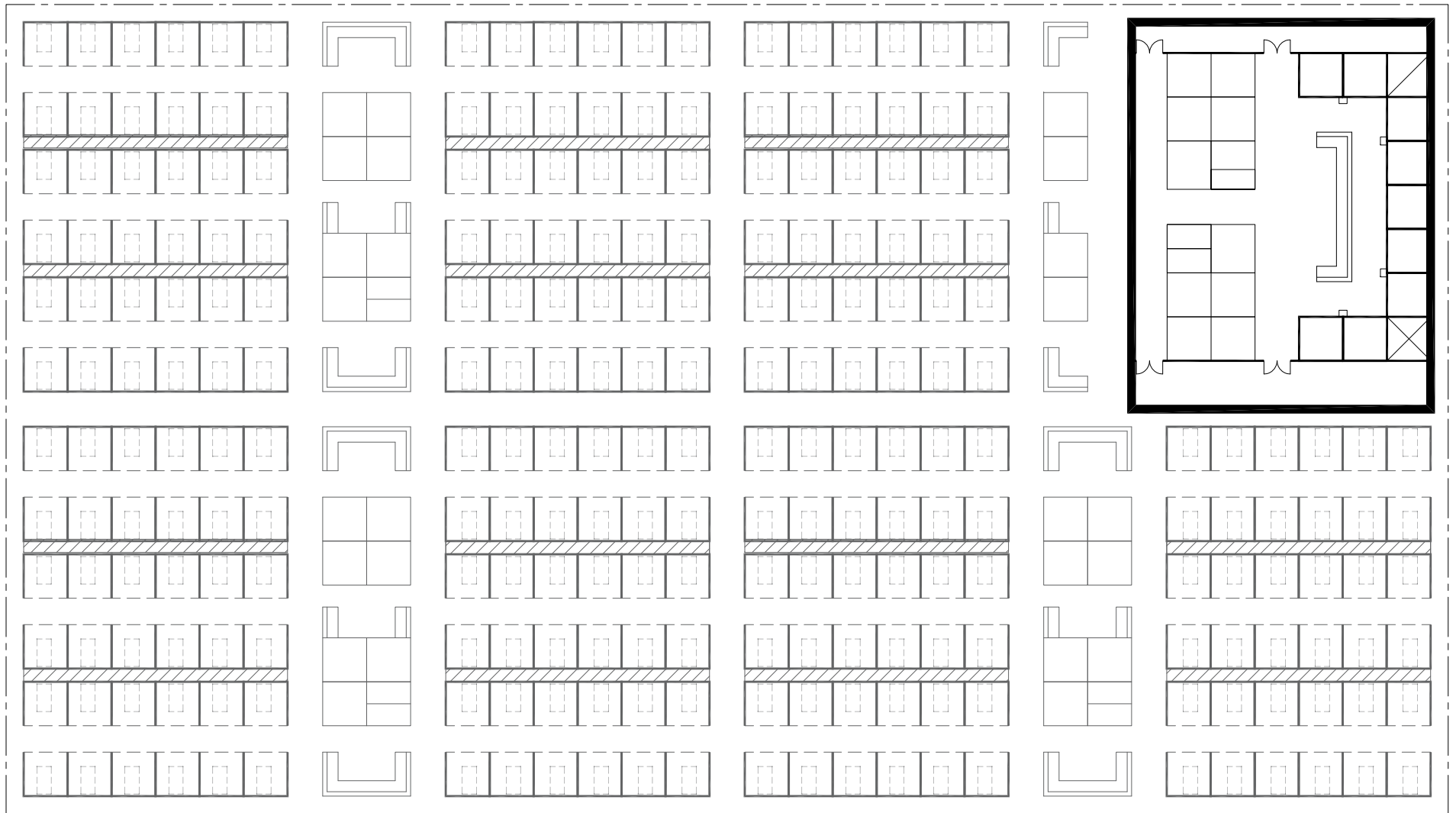

NOTE: FOR A2HC COVID ACUTE DEDICATED AREA - REFERENCE SPECIFIC PWS AND/OR CONCEPTUAL LAYOUTS WITHIN LATEST HNC BINDER

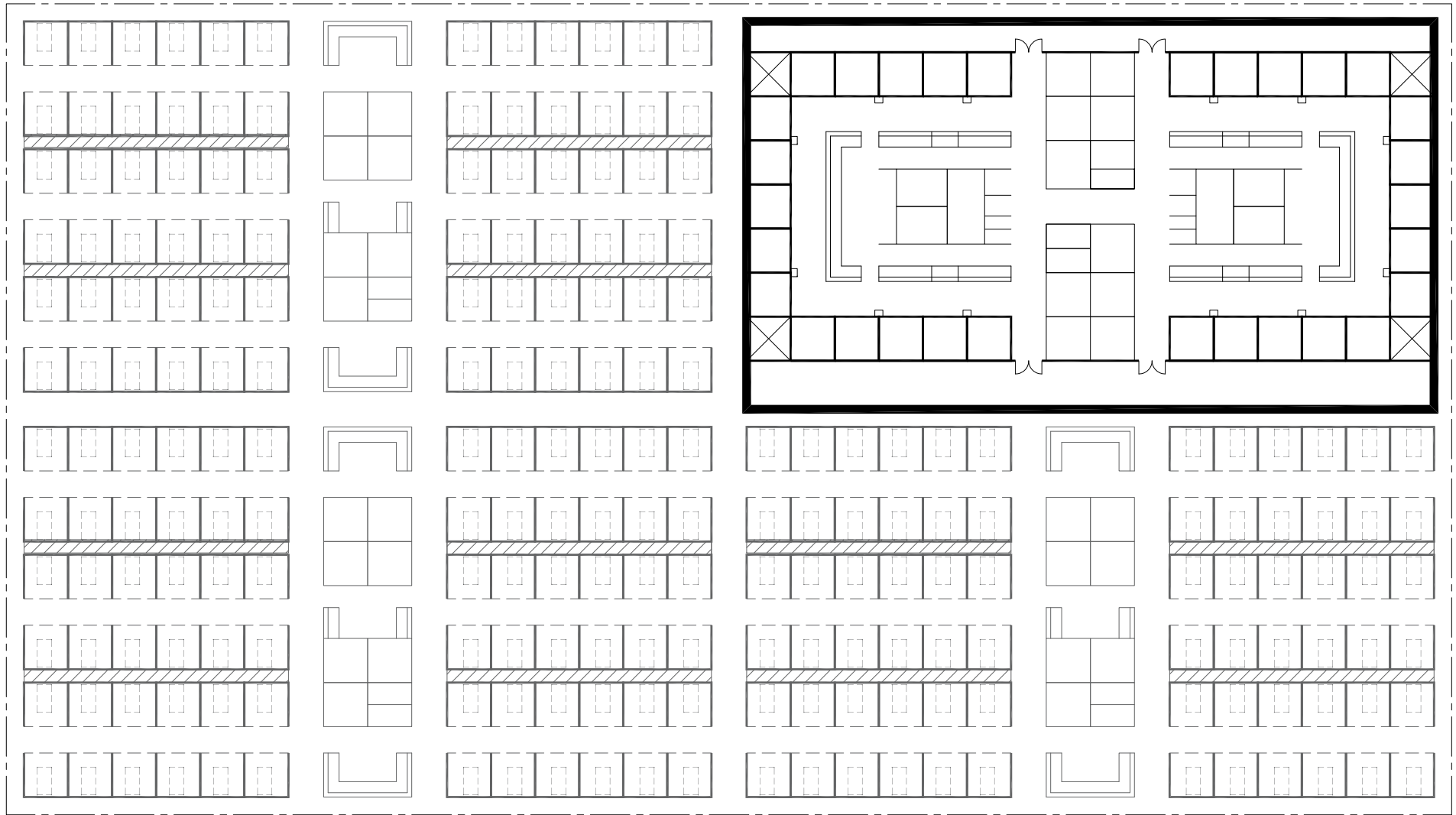

**NOTE: FOR A2HC COVID ACUTE DEDICATED AREA - REFERENCE SPECIFIC PWS AND/OR CONCEPTUAL LAYOUTS WITHIN LATEST HNC BINDER**

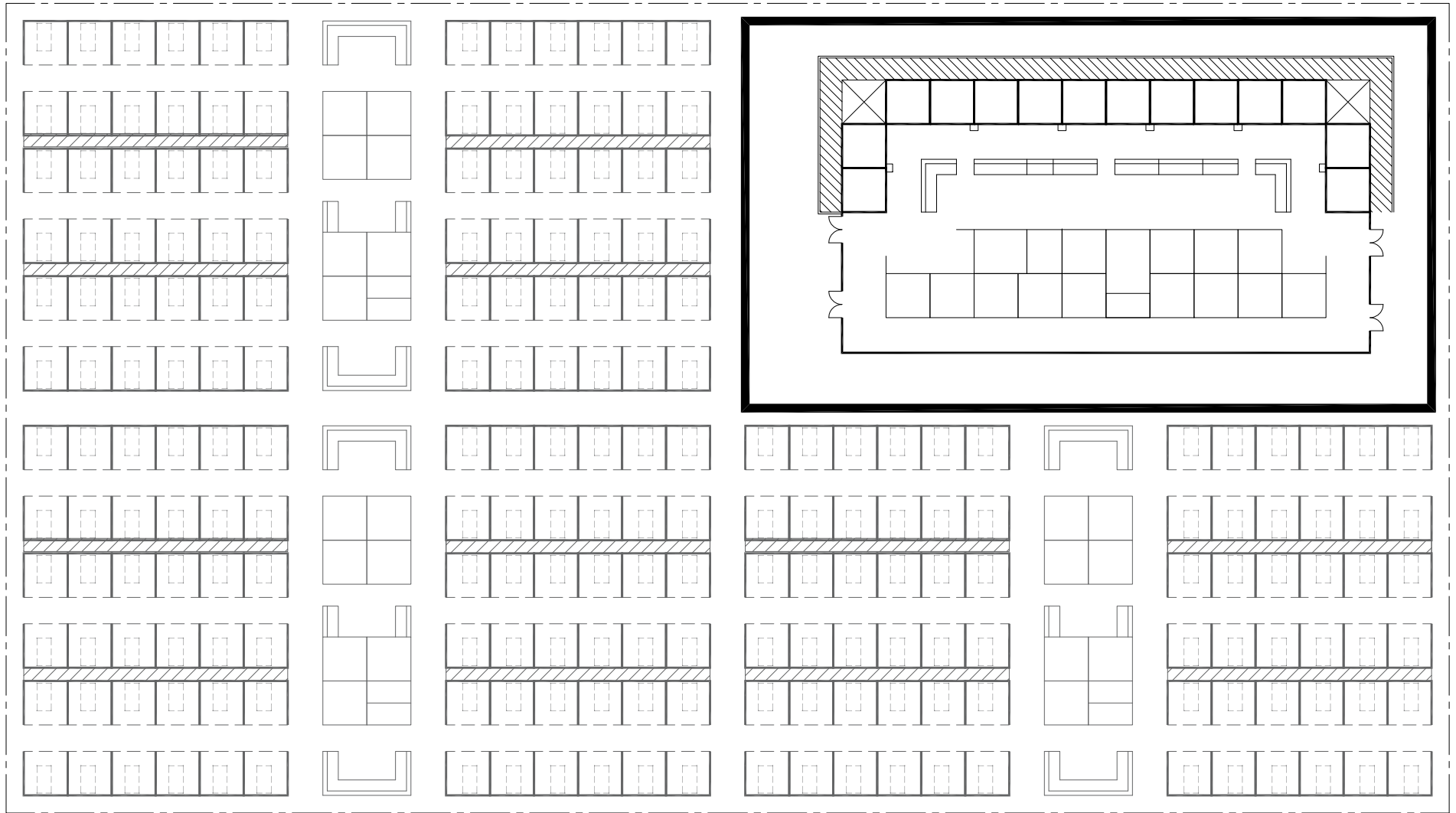

NOTE: FOR A2HC COVID ACUTE DEDICATED AREA - REFERENCE SPECIFIC PWS AND/OR CONCEPTUAL LAYOUTS WITHIN LATEST HNC BINDER

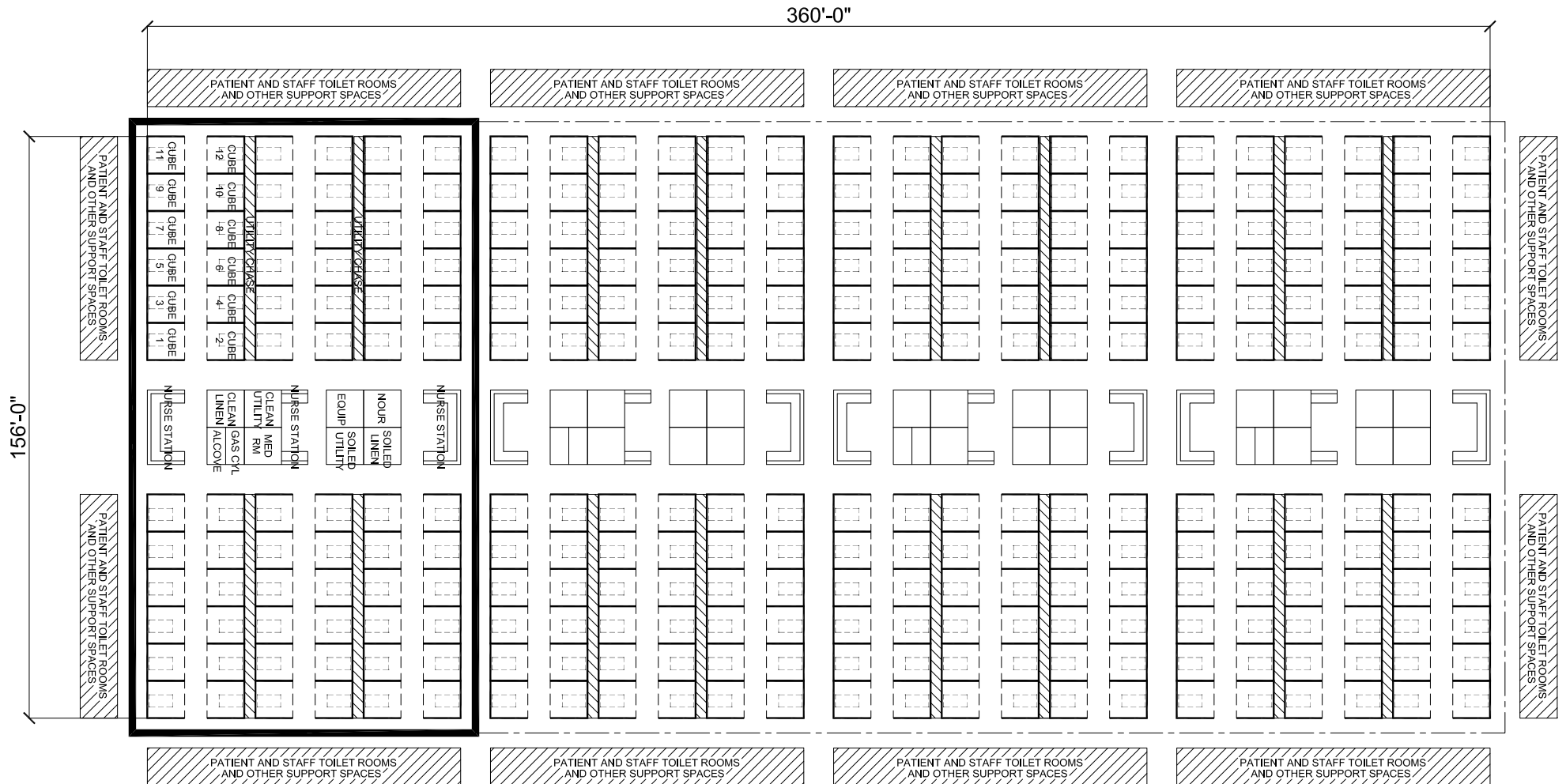

55,160 SF

A2HC - NON-ACUTE COVID+ OPEN AREA/CONVENTION CENTER ARRANGEMENT WITH PERIMETER CORRIDOR/CIRCULATION  
 (4) BLOCK LAYOUT WITH (288) PATIENT ROOMS (CAT 3 SPACES)

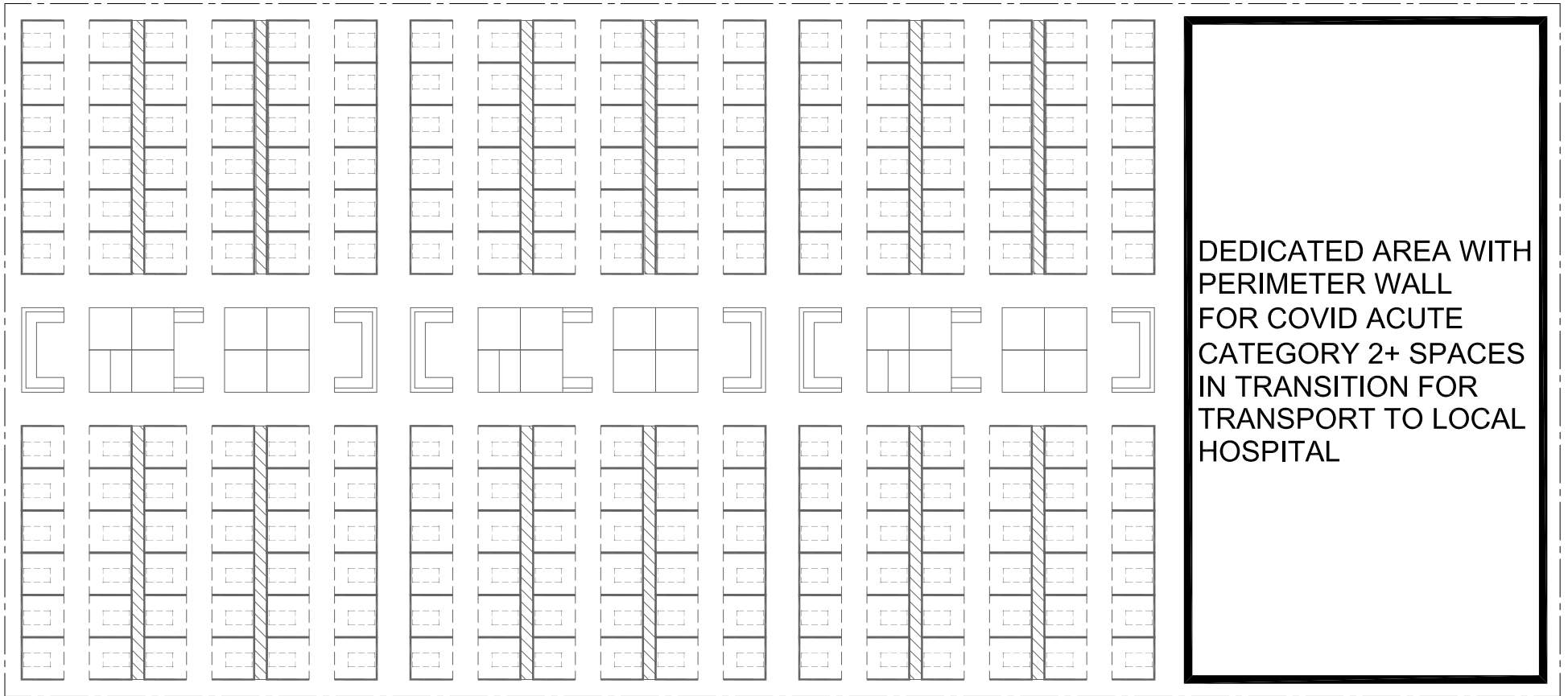

NOTE: FOR A2HC COVID ACUTE DEDICATED AREA - REFERENCE SPECIFIC PWS AND/OR CONCEPTUAL LAYOUTS WITHIN LATEST HNC BINDER